



101 Thompson Street DRUMMOYNE, NSW



2



1

Spacious home with Federation charm amid idyllic gardens

Deposit taken

Beautifully constructed Federation home, this stunning semi is hidden from the road behind a charmed walled garden. It has undergone a renovation incorporating a rear extension with a high-spec Caesarstone kitchen and family room opening to an unexpectedly deep English-style garden. Footsteps to Lyons Road cafes and eateries, it's equidistant to the foreshore at Five Dock Bay and Brett Park

Highlights of the home:

- polished floorboards throughout, original federation features
- Renovated bathroom, laundry and kitchen, skylights.
- Near new Fisher & Paykel fridge
- very close to Drummoyne Public school and catchment of Sydney Secondary College, Balmain

Lindy Klein

0412 839 300

Hilary Lazarus

0414 442 414

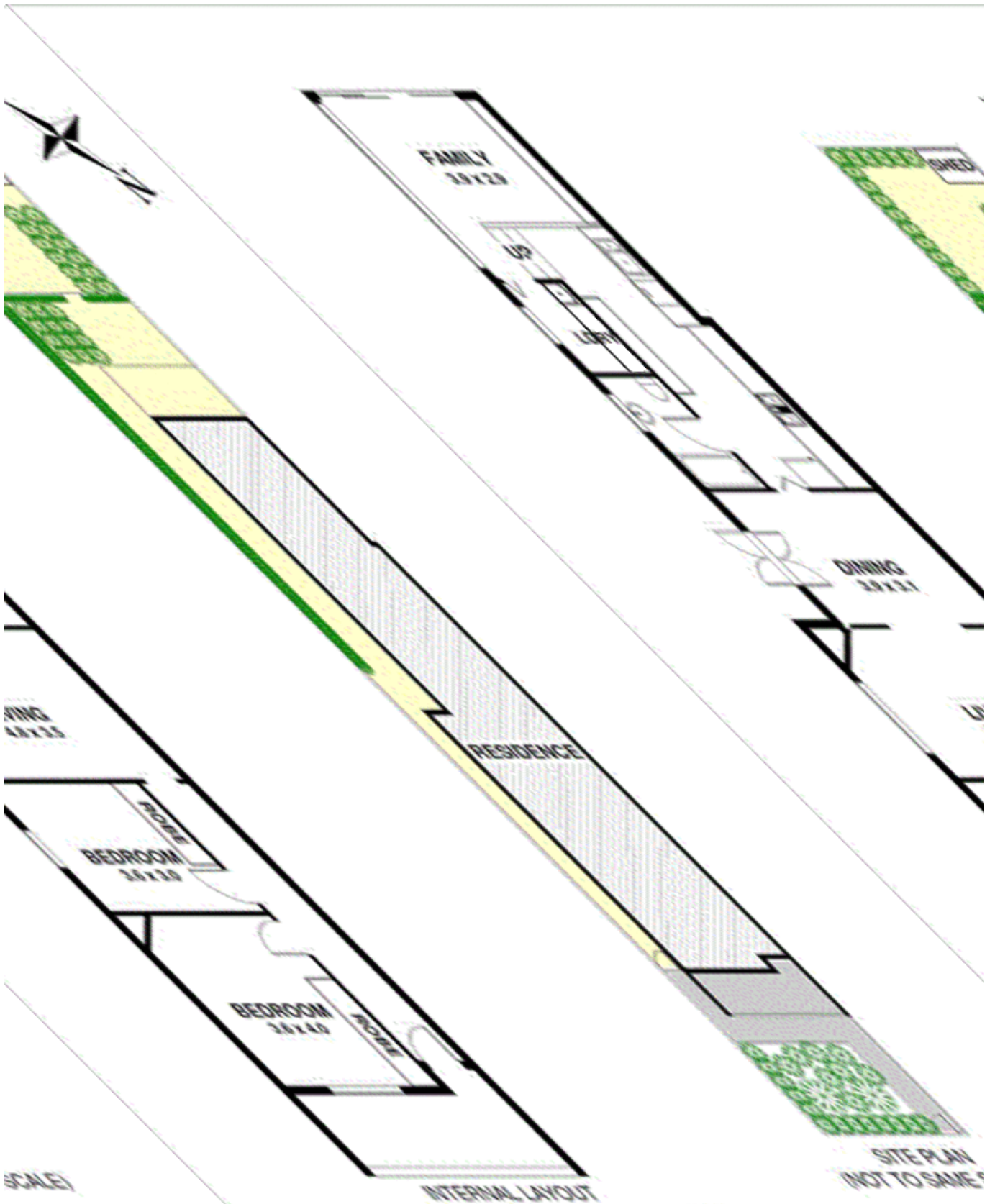

101 Thompson Street, Drummoyne

provided as a guide only. While we trust it to be correct, we cannot guarantee its accuracy. Sizes and areas indicated are approximate only. We have not verified and do not have any liability one way or another in its accuracy. We do not guarantee the accuracy of any information for its accuracy. You should make and rely on their own enquiries in relation to the property.

DISCLAIMER CLAUSE: The information contained in the brochure has been furnished to us by the vendor. The plan is provided as a guide only. While we trust it to be correct, we cannot guarantee its accuracy. Sizes and areas indicated are approximate only. We have not verified and do not have any liability one way or another in its accuracy. We do not guarantee the accuracy of any information for its accuracy. You should make and rely on their own enquiries in relation to the property.

101 Thompson Street

DRUMMOYNE, NSW

