



101 Thompson Street DRUMMOYNE, NSW



2



1

Spacious home with Federation charm amid idyllic gardens

Open to inspect Saturday 16th Dec- 10.30am- 11.00am

Beautifully constructed Federation home, this stunning semi is hidden from the road behind a charmed walled garden. It has undergone a renovation incorporating a rear extension with a high-spec Caesarstone kitchen and family room opening to an unexpectedly deep English-style garden. Footsteps to Lyons Road cafes and eateries, it's equidistant to the foreshore at Five Dock Bay and Brett Park

Highlights of the home:

- polished floorboards throughout, original federation features
- Renovated bathroom, laundry and kitchen, skylights.
- Air con (back area of home)
- very close to Drummoyne Public school and catchment of Sydney Secondary College, Balmain

Lindy Klein

0412 839 300

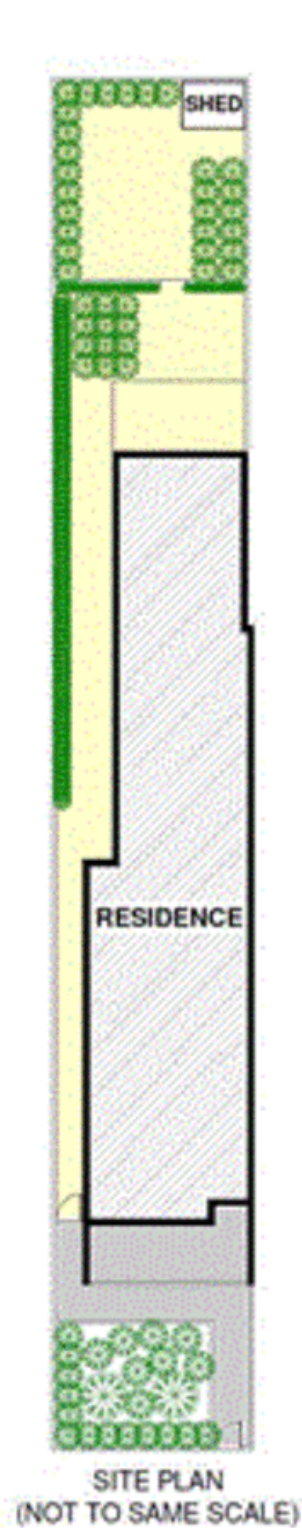
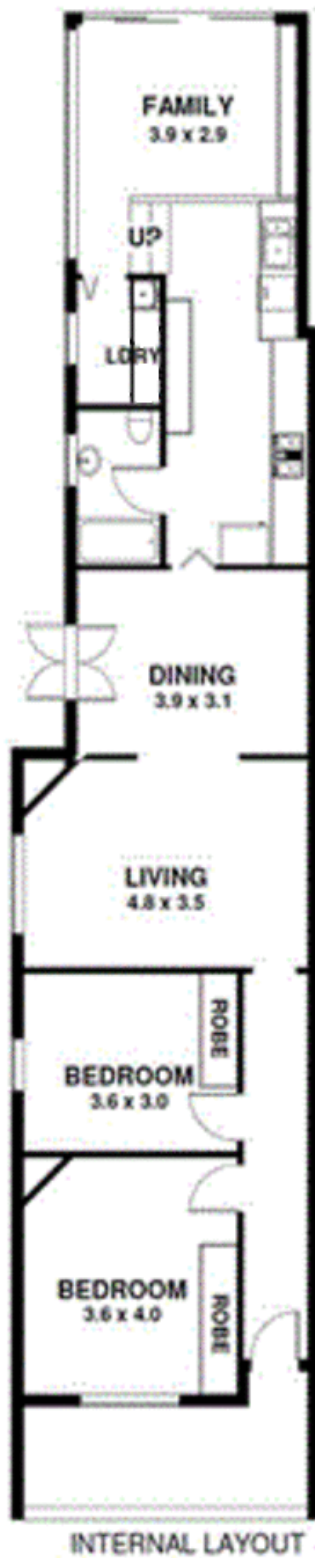

101 Thompson Street, Drummoyne

DISCLAIMER CLAUSE The information contained in this brochure has been furnished to us by the vendors. The plan is provided as a guide only. While we trust it to be correct, we cannot guarantee its accuracy. Sizes and areas indicated are approximate only. We have not verified whether or not that information is accurate and do not have any belief one way or another in its accuracy. We do not accept any responsibility to any person for its accuracy and do not warrant that any associated parties should make and rely on their own enquiries in order to determine whether or not this information is in fact accurate.

101 Thompson Street

DRUMMOYNE, NSW

