

11 Watson Street PADDINGTON, NSW



2



1

Classic and contemporary redesigned terrace in heart of Paddington

INSPECTION CANCELLED- Deposit taken!

Stunning detail in this newly redesigned terrace beautifully harmonises old world character and contemporary sophistication. Nestled in a quiet cul-de-sac, it's mere footsteps from Oxford Street dining and nightlife.

- Exposed brickwork and decorative fireplace add to period charm
- Bright open layout creates incredible sense of spaciousness
- Blackbutt timber floors throughout lounge and dining areas
- North easterly aspect amplifies sunlight both indoors and out
- Corian finished kitchen with European appliances and induction stove
- Two top floor bedrooms, main with integrated wardrobe space
- Bedrooms step through French doors to private alfresco areas one furnished.

Hilary Lazarus

0414 442 414

Lindy Klein

0412 839 300

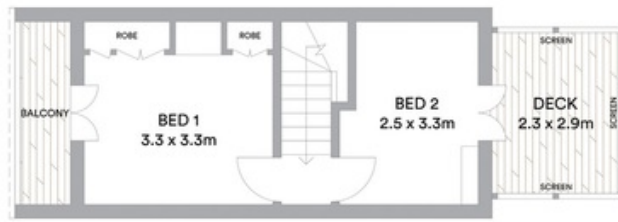

FIRST FLOOR



GROUND FLOOR



Scale in metres. Indicative only. All information contained herein is obtained from sources we believe to be accurate. We cannot guarantee its accuracy. Interested persons should make and rely on their own enquiries

11 Watson Street

PADDINGTON, NSW

