



15 Leverton Close ST IVES, NSW



4



2.5



2

Immaculately presented family home with serenity of stunning Bush Views

Privacy, tranquillity and ambiance are sure to impress in this quiet cul de sac setting overlooking Garrygal National Park.

The house is located within a 10 minute walking distance of; St Ives Primary School, St Ives High School, Masada College and Corpus Christi Primary School, with transport & St Ives Shopping precinct only minutes away.

Features:

- Light filled spacious home with flexible floor plan to allow a choice of living options
- Ducted air conditioning has been installed to upper level rooms kitchen/family room, main bedroom and lounge/dining room & piped gas points throughout kitchen/family room, lounge

Hilary Lazarus

0414 442 414

Yvonne Zheng

0436 195 888

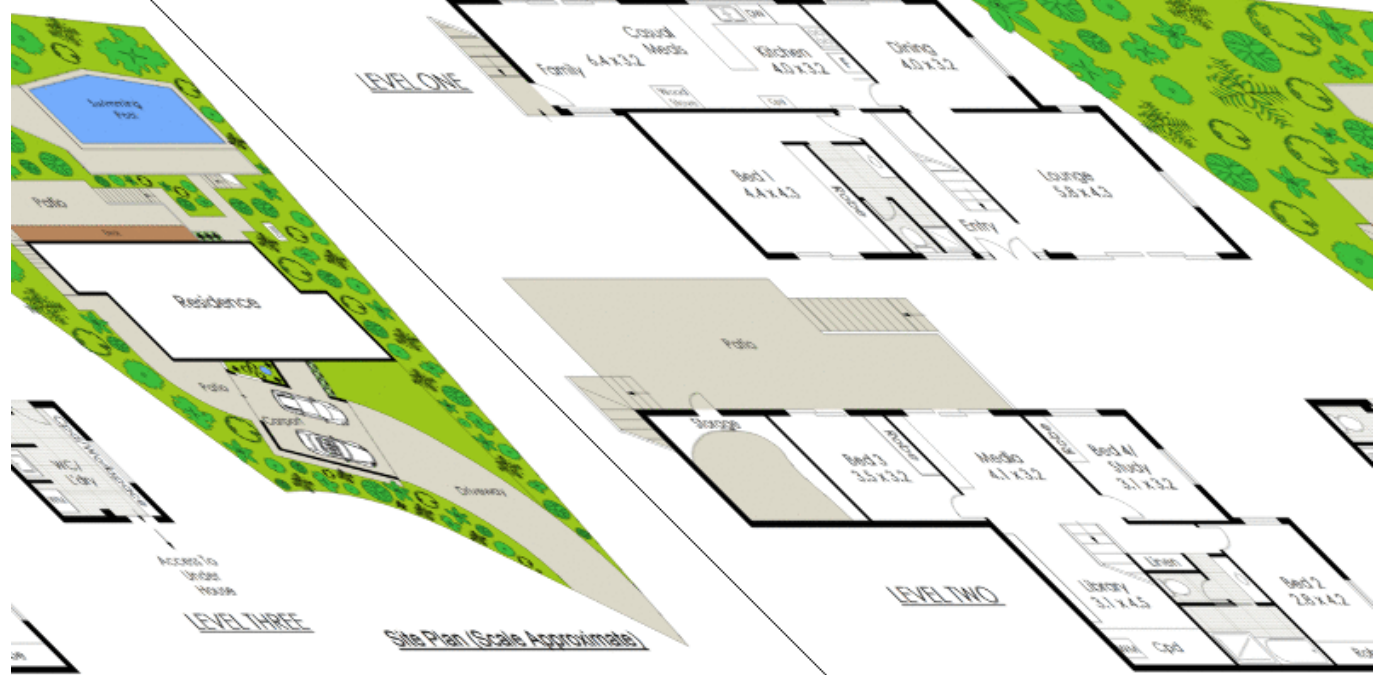

Site Plan (Scale Approximate)

15 Leverton Close, St Ives



*Internal area approx. 286 sqm
 *Excludes: Pool, Tennis, Pty. Ltd. A.B.N. 46 143 102 466
 Trading as HILARY LAZARUS REAL ESTATE AUSTRALIA
 Mob: 0462 071 103 1401
 This floor plan is not a legal document and should not be relied upon for any specific facts. Its validity will be accepted.